

## Ground level – People of the Pacific

From the great Pacific navigators – the Polynesians and New Zealand's indigenous people, the Māori – through to the pioneers who settled New Zealand in the 19th century. Visit **The Museum Store** in the Grand Foyer, for gifts and souvenirs inspired by the Museum collection.

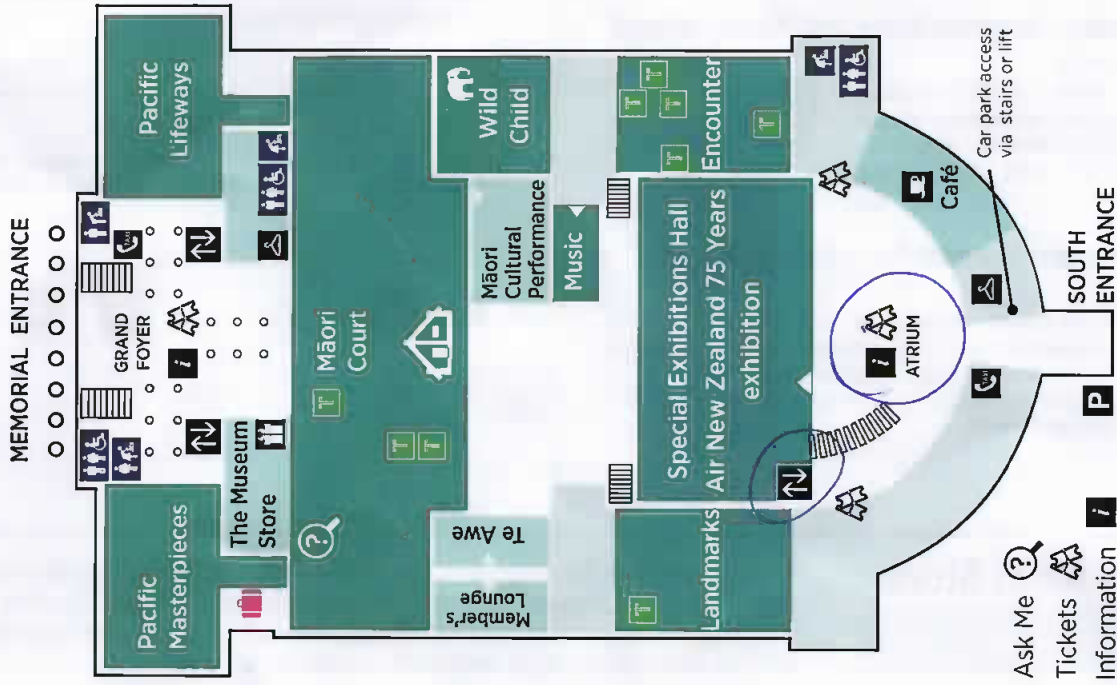

**TE TIRITI  
THE TREATY**  
See overleaf for more info

Excess Baggage  
Display

## Level 1 – Stories of our Land and Sea

Here you will discover what's uniquely ancient about our oceans, forests, volcanoes and animals. From our geological origins to the weird and wonderful flightless creatures for which New Zealand is known – the moa, kiwi and the giant weta.

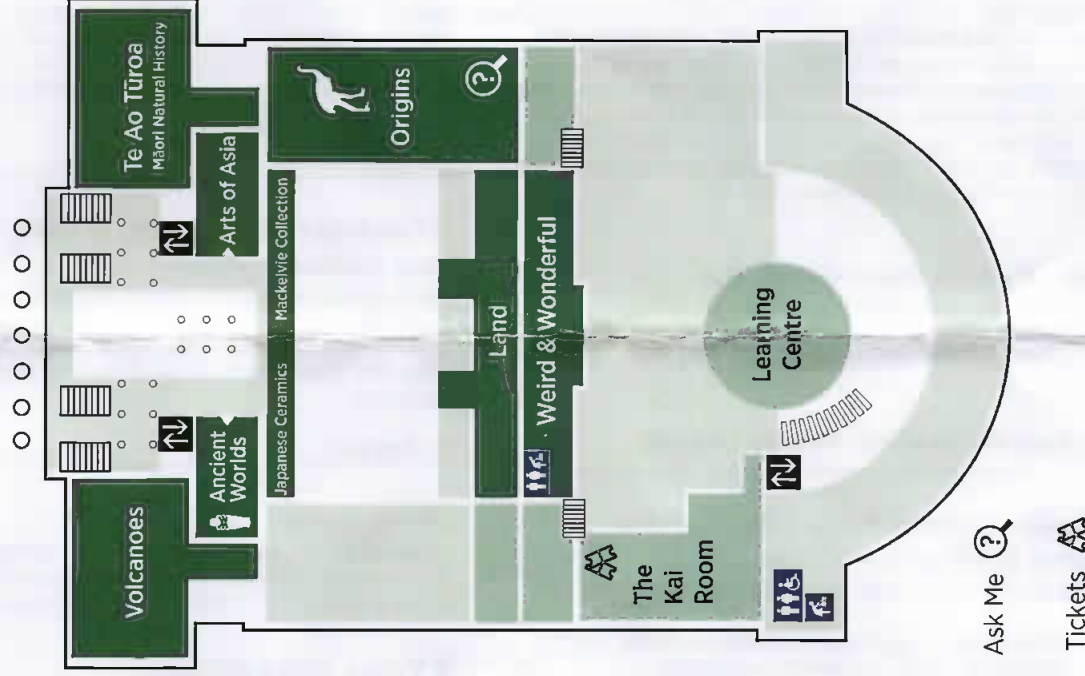

Food is only allowed in the Kai Room

## Level 2 – New Zealand's War Stories

Our war memorial galleries tell the story of New Zealand's involvement in the great conflicts of the 20th century, as well as the New Zealand Wars of the 19th century. This floor houses our Halls of Memory, dedicated to the New Zealand fallen; commemorating in stone the loss and suffering of war.

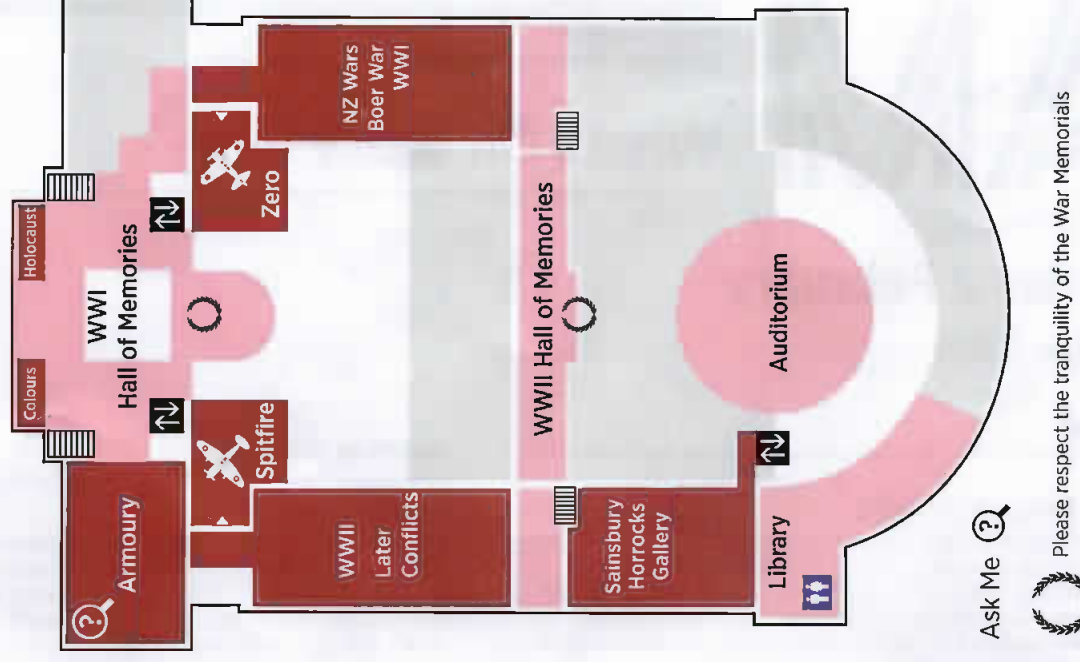



TĀMAKI PAENGA HIRA  
AUCKLAND WAR MEMORIAL MUSEUM

## What's On Today

### Tuesday 2 February

### 10AM – 5PM

#### EXHIBITIONS

##### Air New Zealand 75 Years

*Special Exhibitions Hall, FREE with Museum entry*

Come on a journey through the decades in this interactive, fun and exciting exhibition. Featuring the real stories, romance and glamour of flying, the exhibition explores Air New Zealand's 75 years of growth and innovation and tells the story of New Zealand's national airline through the experiences of the people: airline staff and customers.

##### Excess Baggage

*Between Māori Court and Pacific Masterpieces, FREE with Museum entry*  
Aotearoa New Zealand is a country built on travel. Have bag will travel – and 150 years ago it was no different. Excess Baggage shows you some of the luggage taken on journeys during the 19th and 20th centuries, from top-hat boxes, to vanity cases and picnic sets. Some travelled first class, others cattle class. Some of them are handsome and some are humble. All of them are a record of a people on the move.

##### Çanakkale - Road to Peace Out of War

*The Armoury, FREE with Museum entry*

These photographs commemorate the 100th anniversary of the Battle of Çanakkale, also known as the Gallipoli Campaign.

#### GUIDED TOUR AND CULTURAL PERFORMANCE PACKAGES

##### Moa Package – Museum Entry, Māori Cultural Performance and Highlights Tour

*10.45AM, 11AM, 12PM, 1.30PM, 2.30PM, charges apply – book at ticket desks*

Our GIANT package – explore the museum with our wonderful guides then experience a vibrant and entertaining cultural performance.

##### Tui Package – Museum Entry and Māori Cultural Performance

*11AM, 12PM, 1.30PM, 2.30PM, charges apply – book at ticket desks*  
Enjoy a vibrant and entertaining glimpse of Māori culture including the world famous haka. Your Māori cultural performance includes the opportunity to meet, talk and take photos with our friendly performers.

##### Kiwi Package – Museum Entry and Highlights Tour

*10.45AM, 12.45PM, 2.15PM, charges apply – book at ticket desks*  
Gain insider information from our wonderful guides who share their knowledge about our most famous collections including the traditional voyaging waka and meeting house, our unique natural history and Hall of Memories.

#### WHAT'S ON TODAY

##### Pose with the Nose

*Daily until 17 Feb, 10AM – 4.30PM, outside southern atrium entrance, FREE*  
To celebrate the Air New Zealand 75 Years exhibition we are hosting the cockpit of a Boeing 737! Check it out, take a pic with the nose, and share your snap on Twitter or Instagram with #PoseWithNose to be in to win Air NZ 75th Anniversary spot prizes!

##### Te Tiriti the Treaty - Waitangi 175 - Gallery Trail

*Daily, Museum Galleries, FREE with Museum entry*

We have a selection of nine installations on our ground floor that examine new aspects of the Treaty through our objects. Look out for the green signage in the Museum. [See map for installation locations](#)

#### UPCOMING

##### Home Front - Experiences of the First World War in New Zealand

*Opens 26 Feb, Sainsbury Horrocks Gallery, FREE with Museum entry*  
Focusing on life 'at home' during the First World War, the Home Front exhibition will explore how events half a world away shaped lives at home. This is the third in a series of WWI Centenary commemorative exhibitions.

#### WHAT'S HOT

##### Dining Options

Columbus Café in the Atrium offers a fine selection of kiwi fare or enjoy your own refreshments in The Kai Room on the first floor. The easiest access is through the southern entrance via the Atrium.

##### A Venue with a Difference

Looking for a unique setting for your next event? Discover Auckland's most iconic venue for hire. Ask us what we can create for you: + 64 9 302 9764, [mvevent@aucklandmuseum.com](mailto:mvevent@aucklandmuseum.com)

#### MUSEUM LIBRARY

*Open 10AM – 5PM, Monday – Saturday, level 2*

Browse the Library's reference books, and research the rich collection of manuscripts, historical photographs and maps.

Follow us:



## The Museum Store

Discover more at the Museum Store. Visit our store in the Grand Foyer and check out the great range of products, gifts and souvenirs inspired by the Museum collection. Take home a memory of your visit. Every purchase supports your Museum. Visit us onsite or online at: [aucklandmuseum.com/store](http://aucklandmuseum.com/store)